



Connected Appliances Roadmapping Working Group (CARWG?)

**Melissa Fiffer, U.S. EPA
June 15, 2016**

Using GoToWebinar

Use this button to expand or minimize your toolbar at any time.

If you are using your telephone:

- Select the “Use Telephone” button.
- Dial in and enter your Access Code.
- Enter your audio PIN and press #.

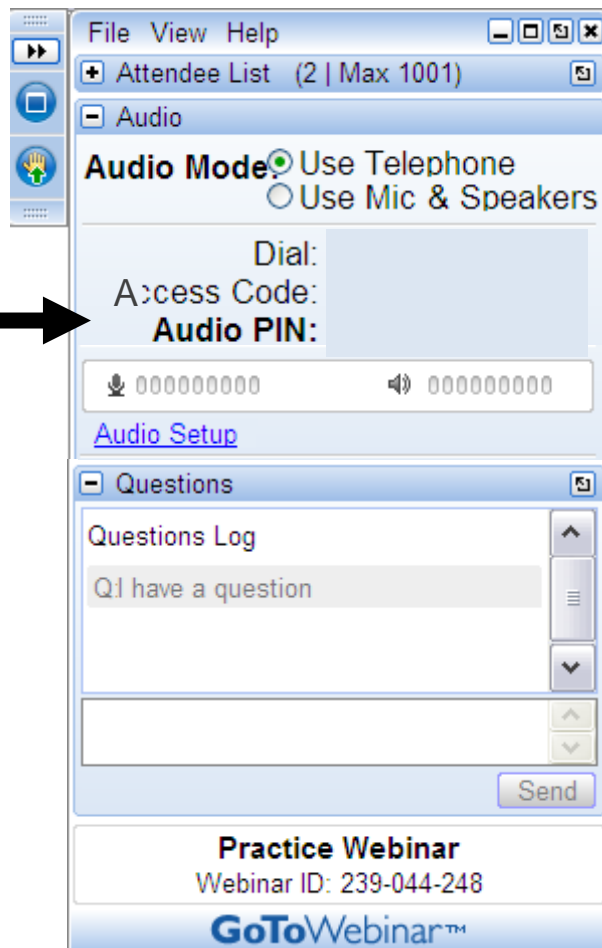

If you are using the speakers on your computer:

- Select the “Use Mic & Speakers” radio button.
- Unmute your desktop.
- Click on Audio Setup if you’re having any difficulty.

Everyone will be muted, but you can type in questions at any time and we’ll answer them at the end of the presentation.

Using GoToWebinar cont.

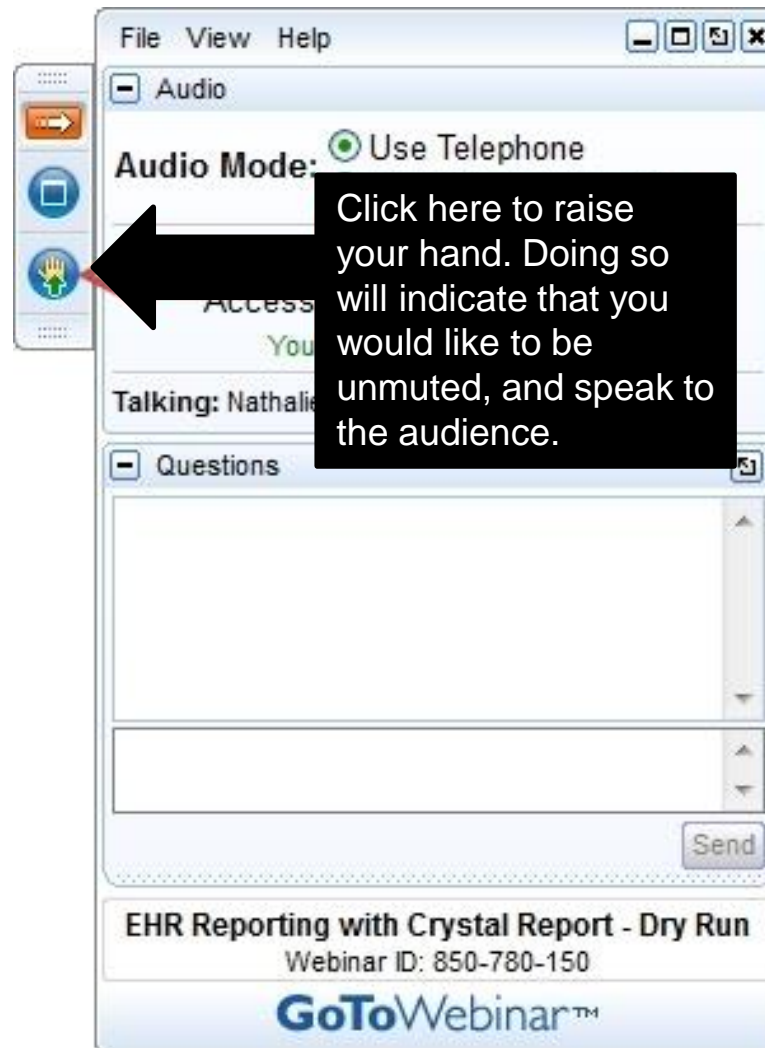



Today's Agenda

- Review objectives and outcomes of the workgroup.
- Review access to and development of shared resources.
- Welcome interested partners/stakeholders to take on leadership roles.
- Plan out follow-up - timeline, process and preparation.



Proposed Working Group Objectives

- **Connect** partners and stakeholders in the connected market: manufacturers, retailers, utilities, utility organizations and service providers.
- **Raise understanding** of the barriers and opportunities for connected appliances from the perspectives of all stakeholders.
- **Provide a clearinghouse/exchange forum** on existing information and research in the connected space, as well as response to questions on technical elements of ENERGY STAR connected criteria.
- **Develop drafts** of ENERGY STAR partner resources, tools and consumer messaging.



Proposed Outcomes

- **Stakeholder Profiles.** List of stakeholders and contact info.
- **Clearinghouse.** EPA will host a clearinghouse/exchange forum with several topics of interest.
- **Technical Q&A.** EPA will host an interactive Q&A document for technical questions raised.
- **ENERGY STAR Partner Resources.** Develop resources on connected products for the ENERGY STAR website, marketing and partner resources.



Shared Resource – Connected Appliances

- On Google Drive – “ENERGY STAR Connected Appliances” folder
 - Configured as restricted access
 - Currently includes three files
 - Connected Appliance Resources and Studies
 - Q&A ENERGY STAR Connected Appliance Criteria
 - Connected Appliance Stakeholders List – please add your info!



Shared Resource – Connected Appliances

- This resource is for you to:
 - Learn
 - Share information and studies on connected appliances
 - Network, and
 - Advance the connected appliance value proposition
- Please visit and contribute to the resource!



Shared Resource – Connected Appliances

- To request access:
 - provide Doug Frazee dfrazee@icfi.com or Laura Wilson lwilson@navitas-partners.com with your contact information as well as your gmail address
 - Google account is required, so if you are not a current user, please [register for an account](#)

Shared Resource – Connected Appliances

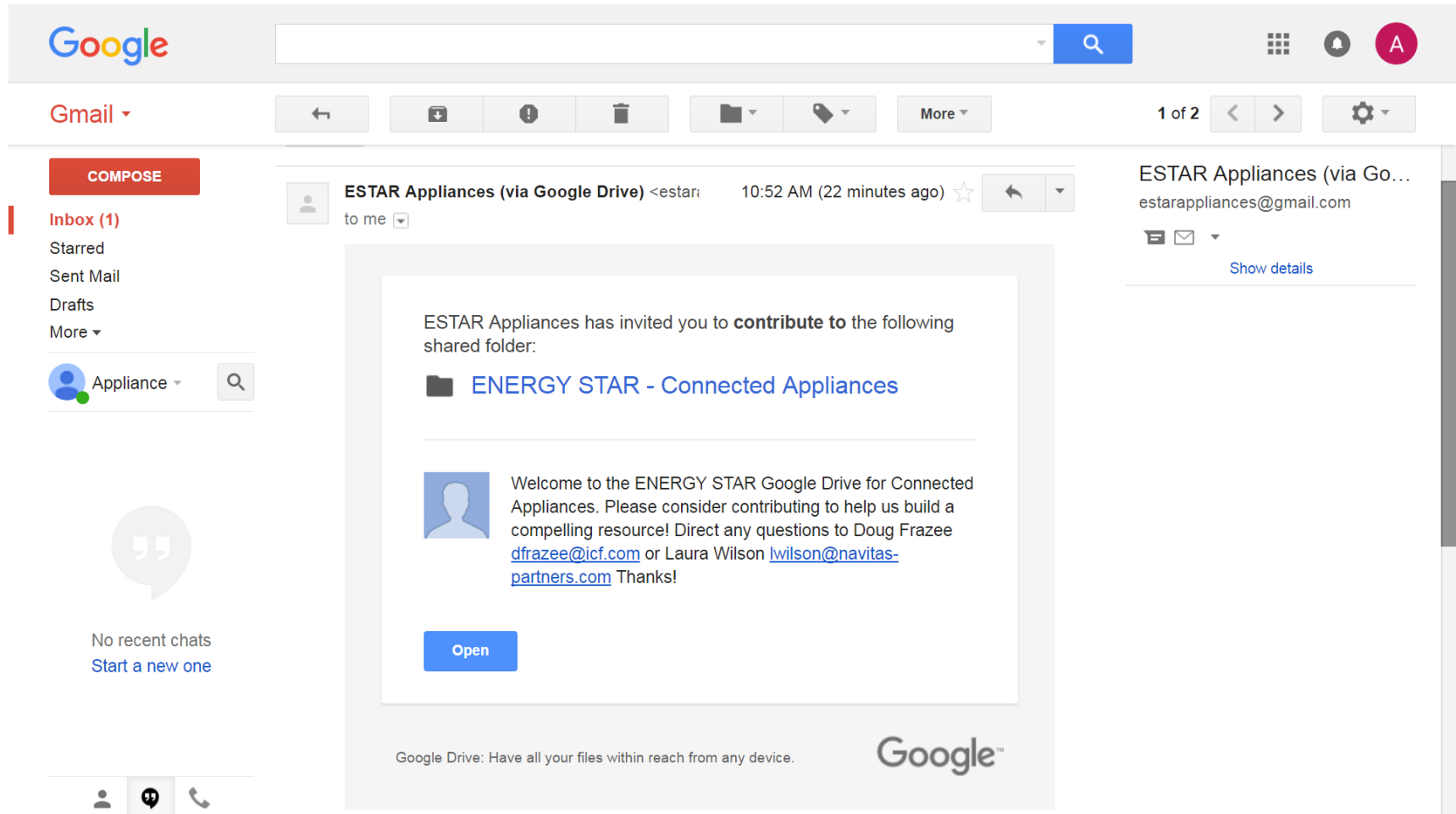

The screenshot shows a Gmail inbox on a desktop. The top bar includes the Google logo, a search bar, and navigation icons. The left sidebar shows the 'COMPOSE' button and the 'Inbox (1)' section. The main email view displays an invitation from 'ESTAR Appliances (via Google Drive)' received 22 minutes ago. The email content states: 'ESTAR Appliances has invited you to **contribute to** the following shared folder: **ENERGY STAR - Connected Appliances**'. Below this, a welcome message is addressed to the user, asking them to consider contributing to help build a resource, and providing contact information for Doug Frazee (dfrazee@icf.com) and Laura Wilson (lwilson@navitas-partners.com). A blue 'Open' button is visible at the bottom of the email content. The right sidebar shows the email header with the sender's name and email address, and a 'Show details' link. The bottom of the interface shows the Google Drive logo and the text 'Google Drive: Have all your files within reach from any device.'



Development of Shared Resources

- **Stakeholder Profiles.** Contribute your information, interests, questions.
- **Clearinghouse.** Contribute references and links for research papers, industry and literature sources with a short summary of the information each provides.
- **Technical Q&A.** Provide questions here for the EPA team to provide clarification.
- **ENERGY STAR Partner Resources.** Propose ideas on ENERGY STAR messaging, marketing initiatives/tools, and website.



Call for Co-Facilitators and Contributors

- Eileen Eaton, CEE has graciously agreed to be a co-facilitator.
 - Thank you, Eileen!
- We welcome interested partners and stakeholders who want to take on a leadership role. Consider:
 - Are you interested in helping shape the outcomes of this working group?
 - Do you have big picture ideas on how ENERGY STAR appliances should evolve in the connected space?
 - Do you have questions for fellow partners and stakeholders navigating the connected space?
- Some examples of what stepping forward might look like:
 - Lead efforts on one of the shared resources, populating the document and encouraging others to contribute
 - Present your organization's current efforts or thought questions around connected during future working group meetings
 - Act as a co-facilitator for discussions during future working group meetings



Next Steps

- Finale will be at the ENERGY STAR Partner Meeting in New Orleans, LA from 9:00am to 12:00pm on October 25
- Before this meeting:
 - In-person meeting in DC or two calls this summer
 - Timing
- Preparations for the next meeting



Connected Appliance Working Group Contacts

- Melissa Fiffer, US EPA
fiffer.melissa@epa.gov
- Doug Frazee, ICF International
douglas.frazee@icfi.com
- Laura Wilson, Navitas Partners
lwilson@navitas-partners.com
- Eileen Eaton, CEE
eeaton@cee1.org

Thank you for participating!

*Check for updates on the
[Appliance Roadmapping
web site](#)*